

AGENDA ITEM NO.

TRAFFORD COUNCIL

THE LICENSING SUB-COMMITTEE – 26TH SEPTEMBER 2016

REPORT OF THE HEAD OF REGULATORY SERVICES

REPORT REF. NO.

APPLICATION FOR THE GRANT OF A MAJOR VARIATION TO PREMISES LICENCE PL000579 - DAVYHULME PARK GOLF CLUB, GLENEAGLES ROAD, URMSTON, MANCHESTER, M41 8SA

PURPOSE

To advise Members of an application for the Grant of a Major Variation to existing premises licence PL000579 for Davyhulme Park Golf Club, Gleneagles Road, Urmston, Manchester, M41 8SA.

The application has attracted representations from local residents.

OPTIONS

The Sub-Committee to take such steps as they consider necessary for the promotion of the Licensing Objectives in accordance with the provisions of subsection 18 (4) of the Licensing Act 2003.

Iain Veitch
Head of Regulatory Services

Further Information From:
Name: Jan Taylor
Licensing Officer
Extension: 4047

Proper Officer for the purposes of L.G.A 1972,S.100D
(background papers): Head of Regulatory Services

Appendices:

Appendix A – Application and Operating Schedule (including layout of premises).

Appendix B – Existing Premises Licence PL000579.

Appendix C – Representations from local residents (plotted on diagram) :

C1 – Nelson

C2 – Corrigan

C3 - Martin

C4 – Murphy

C5 – Seccombe

1. Background

- 1.1 Davyhulme Park Golf Club, is located on Gleneagles Road in Urmston and is a company run members golf club which has existed at the location since September 1923.

The Premises currently benefits from premises licence PL000579 (**Appendix B**).



2. Application for the Grant of a Variation to Premises Licence (PL000579)

- 2.1 On 29th July, 2016 the Licensing Section received an application (**Appendix A**) from Mr Keith Melia, General Manager, on behalf of Davyhulme Park Golf Club Limited who own the premises.
- 2.2 The application requests the granting of a major variation to the existing premises licence (**Appendix B**) to increase the Supply of Alcohol on the premises on Sunday's only.
- 2.3 The application requests the change of the licensable activity for Sale of Alcohol (on the premises) as follows:

Sale of Alcohol (on the premises):

Existing	-	Sunday	:	Noon – 22:30
Application	-	Sunday	:	10:00 – 23:30

- 2.4 All other hours and conditions remain the same.
- 2.5 The applicant has complied with all requirements under the application process including advertising the application in a newspaper, advertising by way of public notice at the premises and submitting a copy of the complete application to all Responsible Authorities. The application is deemed to be correctly submitted.

3. Representations

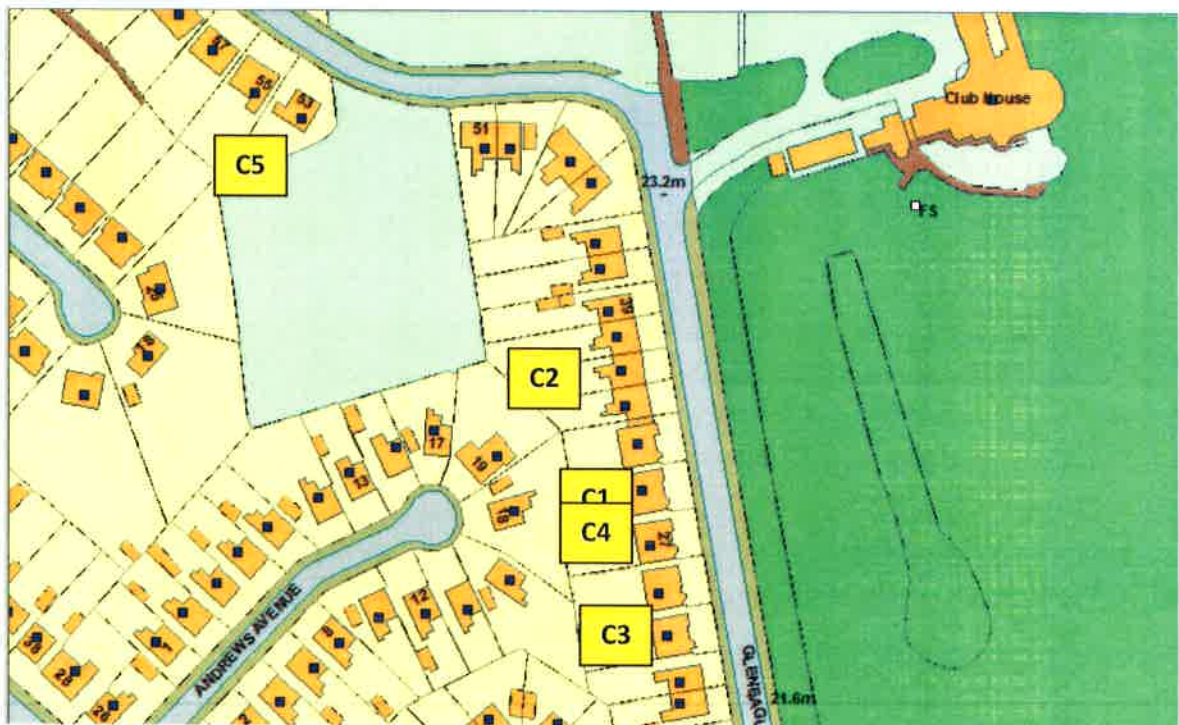

- 3.1 During the consultation period, representations were received from local residents (**Appendix C – 1 to 5**).
- 3.2 The Committee are respectfully advised that the representations received against the application broadly relate to the Licensing Objectives:
- Prevention of Public Nuisance
 - Prevention of Crime and Disorder
- 3.3 The Members are advised that The Government's Guidance states that it is not sufficient for an objector to simply state that they wish to object, or that they are objecting on noise grounds. A representation should give more detail of the likely impact should the licence be granted.
- 3.4 It is recommended that, in borderline cases, the benefit of the doubt about any aspect of a representation should be given to the person making that

representation. The subsequent hearing would then provide an opportunity for the person or body making the representation to amplify and clarify it.

3.7 The Members are therefore required to determine the relevance of all representations.

3.8 When considering the relevance of any representation the Licensing Sub-Committee must be aware that :

- i. the representation can be from any person or body;
- ii. it must not be repetitious, vexatious or frivolous;
- iii. it must relate to one or more of the licensing objectives.

4. Licensing Policy and Guidance

4.1 The Committee are respectfully referred to the Council's own Licensing Policy relating to the Licensing Act 2003 objectives and to the Secretary of State's Guidance. (Copy available at meeting)

5. Options

5.1 The Sub-Committee to take such steps as they consider necessary for the promotion of the Licensing Objectives in accordance with the provisions of subsection (4) of the Licensing Act 2003. The steps specified are:

5.1.1 To grant the licence subject to-

- Conditions consistent with the operating schedule accompanying the application modified to such extent as the authority considers necessary for the promotion of the licensing objectives, and;
- Any mandatory conditions which must be included under the Licensing Act 2003

5.1.2 to exclude from the scope of the licence any of the licensable activities to which the application relates;

5.1.3 to refuse to specify a person in the licence as the premises supervisor;

5.1.4 to reject the application.

5.2 The Sub-Committee is advised that any findings on any issues of fact should be on the balance of probability and any decision should be based on the individual merits of the application.

5.3 The Sub-Committee, in arriving at its decision, must have regard to relevant provisions of national guidance and its own statement of licensing policy and reasons should be given for any departure.

APPENDIX A

APPLICATION AND OPERATING SCHEDULE (including premises layout)

PL 000579

LA 0325/16



TRAFFORD COUNCIL



ULD XXX GLEN / I

LD0:26/8

AHW500225137

061391

£190 Debit

Application to vary a premises licence under the Licensing Act 2003

PLEASE READ THE FOLLOWING INSTRUCTIONS FIRST

Before completing this form please read the guidance notes at the end of the form. If you are completing this form by hand please write legibly in block capitals. In all cases ensure that your answers are inside the boxes and written in black ink. Use additional sheets if necessary. You may wish to keep a copy of the completed form for your records.

I/We DAVYHULME PARK GOLF CLUB
(Insert name(s) of applicant)

being the premises licence holder, apply to vary a premises licence under section 34 of the Licensing Act 2003 for the premises described in Part 1 below

Premises licence number	PL 0579
-------------------------	---------

Part 1 – Premises Details

Postal address of premises or, if none, ordnance survey map reference or description			
DAVYHULME PARK GOLF CLUB LTD GLENEAGLES ROAD DAVYHULME MANCHESTER			
Post town	MANCHESTER	Post code	M41 8SA

Telephone number at premises (if any)	0161 - 748 - 2260
Non-domestic rateable value of premises	£ 30,000

Part 2 – Applicant details

Daytime contact telephone number	0161 - 748 - 2260
E-mail address (optional)	gm@davyhulmeparkgolfclub.co.uk

Current postal address if different from premises address			
Post Town		Postcode	

Part 3 - Variation

Please tick yes

Do you want the proposed variation to have effect as soon as possible?

If not do you want the variation to take effect from

Day	Month	Year

Please describe briefly the nature of the proposed variation (Please see guidance note 1)

TO CHANGE THE HOURS OF SERVICE AVAILABLE ON A SUNDAY

FROM NOON TO 22.00

TO 10.00 HRS TO 23.30 HRS

FOR THE SALE BY RETAIL OF ALCOHOL

If your proposed variation would mean that 5,000 or more people are expected to attend the premises at any one time, please state the number expected to attend

Part 4 Operating Schedule

Please complete those parts of the Operating Schedule below which would be subject to change if this application to vary is successful.

Provision of regulated entertainment

Please tick yes

- a) plays (if ticking yes, fill in box A)
- b) films (if ticking yes, fill in box B)
- c) indoor sporting events (if ticking yes, fill in box C)
- d) boxing or wrestling entertainment (if ticking yes, fill in box D)
- e) live music (if ticking yes, fill in box E)
- f) recorded music (if ticking yes, fill in box F)
- g) performances of dance (if ticking yes, fill in box G)
- h) anything of a similar description to that falling within (e), (f) or (g) (if ticking yes, fill in box H)

Provision of late night refreshment (if ticking yes, fill in box I)

Sale by retail of alcohol (if ticking yes, fill in box J)

In all cases complete boxes K, L and M

A

Plays Standard days and timings (please read guidance note 6)			Will the performance of a play take place indoors or outdoors or both – please tick (please read guidance note 2)	Indoors	<input type="checkbox"/>
				Outdoors	<input type="checkbox"/>
				Both	<input type="checkbox"/>
Day	Start	Finish	Please give further details here (please read guidance note 3)		
Mon					
Tue			State any seasonal variations for performing plays (please read guidance note 4)		
Wed					
Thur			Non standard timings. Where you intend to use the premises for the performance of plays at different times to those listed in the column on the left, please list (please read guidance note 5)		
Fri					
Sat					
Sun					

B

Films Standard days and timings (please read guidance note 6)			<u>Will the exhibition of films take place indoors or outdoors or both – please tick</u> (please read guidance note 2)	Indoors	<input type="checkbox"/>
				Outdoors	<input type="checkbox"/>
				Both	<input type="checkbox"/>
Day	Start	Finish	<u>Please give further details here</u> (please read guidance note 3)		
Mon					
Tue					
Wed			<u>State any seasonal variations for the exhibition of films</u> (please read guidance note 4)		
Thur					
Fri					
Sat			<u>Non standard timings. Where you intend to use the premises for the exhibition of films at different times to those listed in the column on the left, please list</u> (please read guidance note 5)		
Sun					

C

Indoor sporting events Standard days and timings (please read guidance note 6)			<u>Please give further details</u> (please read guidance note 3)
Day	Start	Finish	
Mon			<u>State any seasonal variations for indoor sporting events</u> (please read guidance note 4)
Tue			
Wed			
Thur			<u>Non standard timings. Where you intend to use the premises for indoor sporting events at different times to those listed in the column on the left, please list</u> (please read guidance note 5)
Fri			
Sat			
Sun			

D

Boxing or wrestling entertainments Standard days and timings (please read guidance note 6)			<u>Will the boxing or wrestling entertainment take place indoors or outdoors or both – please tick</u> (please read guidance note 2)	Indoors	<input type="checkbox"/>
				Outdoors	<input type="checkbox"/>
				Both	<input type="checkbox"/>
Day	Start	Finish	<u>Please give further details here</u> (please read guidance note 3)		
Mon					
Tue			<u>State any seasonal variations for boxing or wrestling entertainment</u> (please read guidance note 4)		
Wed					
Thur			<u>Non standard timings. Where you intend to use the premises for boxing or wrestling entertainment at different times to those listed in the column on the left, please list</u> (please read guidance note 5)		
Fri					
Sat					
Sun					

E

Live music Standard days and timings (please read guidance note 6)			<u>Will the performance of live music take place indoors or outdoors or both – please tick</u> (please read guidance note 2)	Indoors	<input type="checkbox"/>
				Outdoors	<input type="checkbox"/>
				Both	<input type="checkbox"/>
Day	Start	Finish	<u>Please give further details here</u> (please read guidance note 3)		
Mon					
Tue					
Wed			<u>State any seasonal variations for the performance of live music</u> (please read guidance note 4)		
Thur					
Fri			<u>Non standard timings. Where you intend to use the premises for the performance of live music at different times to those listed in the column on the left, please list</u> (please read guidance note 5)		
Sat					
Sun					

F

Recorded music Standard days and timings (please read guidance note 6)			Will the playing of recorded music take place indoors or outdoors or both – please tick (please read guidance note 2)	Indoors	<input type="checkbox"/>
				Outdoors	<input type="checkbox"/>
				Both	<input type="checkbox"/>
Day	Start	Finish	Please give further details here (please read guidance note 3)		
Mon					
Tue			State any seasonal variations for the playing of recorded music (please read guidance note 4)		
Wed					
Thur			Non standard timings. Where you intend to use the premises for the playing of recorded music at different times to those listed in the column on the left, please list (please read guidance note 5)		
Fri					
Sat					
Sun					

G

Performances of dance Standard days and timings (please read guidance note 6)			<u>Will the performance of dance take place indoors or outdoors or both – please tick</u> (please read guidance note 2)	Indoors	<input type="checkbox"/>
				Outdoors	<input type="checkbox"/>
				Both	<input type="checkbox"/>
Day	Start	Finish	<u>Please give further details here</u> (please read guidance note 3)		
Mon					
Tue			<u>State any seasonal variations for the performance of dance</u> (please read guidance note 4)		
Wed					
Thur			<u>Non standard timings. Where you intend to use the premises for the performance of dance at different times to those listed in the column on the left, please list</u> (please read guidance note 5)		
Fri					
Sat					
Sun					

H

Anything of a similar description to that falling within (e), (f) or (g) Standard days and timings (please read guidance note 6)			<u>Please give a description of the type of entertainment you will be providing</u>		
Day	Start	Finish	<u>Will this entertainment take place indoors or outdoors or both – please tick</u> (please read guidance note 2)	Indoors	<input type="checkbox"/>
Mon				Outdoors	<input type="checkbox"/>
				Both	<input type="checkbox"/>
Tue			<u>Please give further details here</u> (please read guidance note 3)		
Wed					
Thur			<u>State any seasonal variations for entertainment of a similar description to that falling within (e), (f) or (g)</u> (please read guidance note 4)		
Fri					
Sat			<u>Non standard timings. Where you intend to use the premises for the entertainment of a similar description to that falling within (e), (f) or (g) at different times to those listed in the column on the left, please list</u> (please read guidance note 5)		
Sun					

I

Late night refreshment Standard days and timings (please read guidance note 6)			Will the provision of late night refreshment take place indoors or outdoors or both – please tick (please read guidance note 2)	Indoors	<input type="checkbox"/>
				Outdoors	<input type="checkbox"/>
				Both	<input type="checkbox"/>
Day	Start	Finish	Please give further details here (please read guidance note 3)		
Mon					
Tue			State any seasonal variations for the provision of late night refreshment (please read guidance note 4)		
Wed					
Thur			Non standard timings. Where you intend to use the premises for the provision of late night refreshment at different times, to those listed in the column on the left, please list (please read guidance note 5)		
Fri					
Sat					
Sun					

J

Supply of alcohol Standard days and timings (please read guidance note 6)			Will the supply of alcohol be for consumption (Please tick box) (please read guidance note 7)	On the premises	<input checked="" type="checkbox"/>			
				Off the premises	<input type="checkbox"/>			
				Both	<input type="checkbox"/>			
Day	Start	Finish	State any seasonal variations for the supply of alcohol (please read guidance note 4)					
Mon								
Tue								
Wed								
Thur						Non-standard timings. Where you intend to use the premises for the supply of alcohol at different times to those listed in the column on the left, please list (please read guidance note 5)		
Fri								
Sat								
Sun	10.00	23.30						

K

Please highlight any adult entertainment or services, activities, other entertainment or matters ancillary to the use of the premises that may give rise to concern in respect of children (please read guidance note 8)

N/A

L

Hours premises are open to the public Standard days and timings (please read guidance note 6)			<u>State any seasonal variations</u> (please read guidance note 4)
Day	Start	Finish	
Mon			<u>Non standard timings. Where you intend the premises to be open to the public at different times from those listed in the column on the left, please list</u> (please read guidance note 5)
Tue			
Wed			
Thur			
Fri			
Sat			
Sun			

Please identify those conditions currently imposed on the licence which you believe could be removed as a consequence of the proposed variation you are seeking

Please tick yes

- I have enclosed the premises licence
- I have enclosed the relevant part of the premises licence

If you have not ticked one of these boxes please fill in reasons for not including the licence, or part of it, below

Reasons why I have failed to enclose the premises licence or relevant part of premises licence

M Describe any additional steps you intend to take to promote the four licensing objectives as a result of the proposed variation:

a) General – all four licensing objectives (b,c,d,e) (please read guidance note 9)

No CHANGE

b) The prevention of crime and disorder

No CHANGE

c) Public safety

No CHANGE

d) The prevention of public nuisance

No CHANGE

e) The protection of children from harm

No CHANGE

Please tick yes

- I have made or enclosed payment of the fee
- I have sent copies of this application and the plan to responsible authorities and others where applicable
- I understand that I must now advertise my application
- I have enclosed the premises licence or relevant part of it or explanation
- I understand that if I do not comply with the above requirements my application will be rejected

IT IS AN OFFENCE, LIABLE ON CONVICTION TO A FINE UP TO LEVEL 5 ON THE STANDARD SCALE, UNDER SECTION 158 OF THE LICENSING ACT 2003 TO MAKE A FALSE STATEMENT IN OR IN CONNECTION WITH THIS APPLICATION

Part 5 – Signatures (please read guidance note 10)

Signature of applicant (the current premises licence holder) or applicant's solicitor or other duly authorised agent (please read guidance note 11). If signing on behalf of the applicant please state in what capacity.

Signature	
Date	10 th JUNE 2016
Capacity	GENERAL MANAGER

Where the premises licence is jointly held signature of 2nd applicant (the current premises licence holder) or 2nd applicant's solicitor or other authorised agent (please read guidance note 12). If signing on behalf of the applicant please state in what capacity.

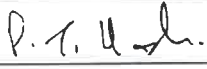
Signature	
Date	10 June 2016.
Capacity	Boss Manager.

Contact name (where not previously given) and address for correspondence associated with this application (please read guidance note 13)

Post town		Post code	
Telephone number (if any)			
If you would prefer us to correspond with you by e-mail your e-mail address (optional)			

**DAVYHULME PARK GOLF CLUB
FIRE ALARM ZONE DIAGRAM**

 Electrical Contractors & Engineers
 Unit 7, Cromwell Road
 Bredbury, Stockport
 SK6 2HF
 T 0161 406 6600
 F 0161 430 8022
 E mail@alardelectrical.com
 www.alardelectrical.com

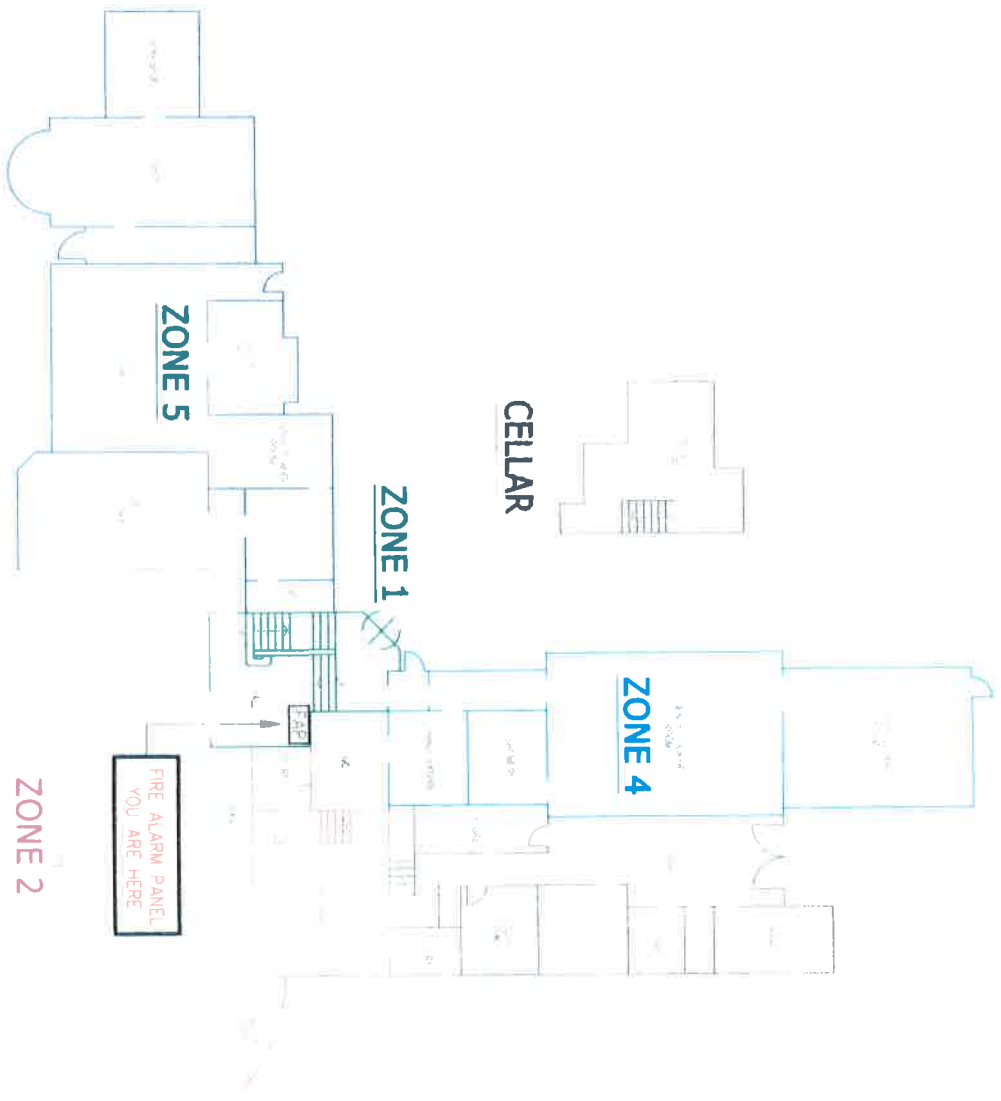

GROUND FLOOR

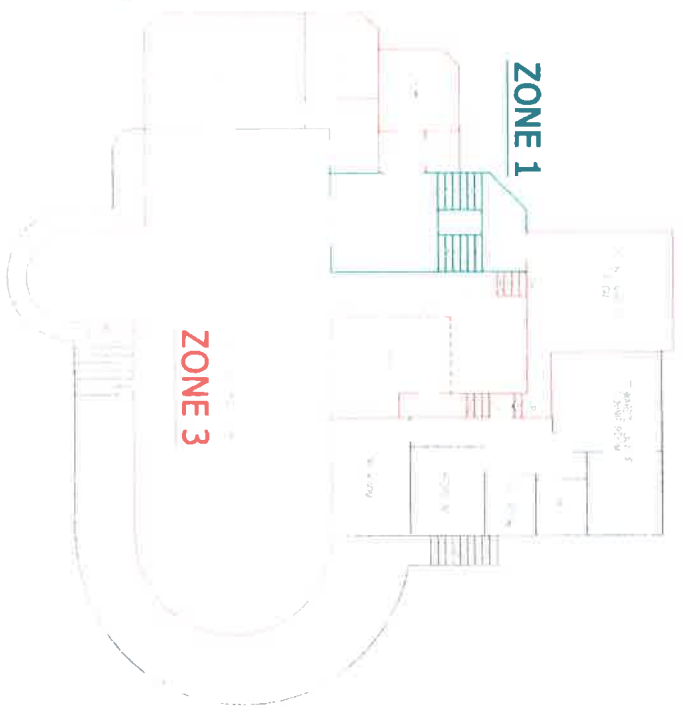

FIRST FLOOR

APPENDIX B

Existing Premises Licence PL000579

Licensing Act 2003

Premises Licence

PL000579

Part 1 - Premises Details

POSTAL ADDRESS OF PREMISES, OR IF NONE, ORDNANCE SURVEY MAP REFERENCE OR DESCRIPTION

Davyhulme Park Golf Club

Gleneagles Road, Davyhulme, Manchester, M41 8SA.

Telephone 0161 748 2260

WHERE THE LICENCE IS TIME LIMITED THE DATES

Not applicable

LICENSABLE ACTIVITIES AUTHORISED BY THE LICENCE

- a performance of a play
- an exhibition of a film
- an indoor sporting event
- a performance of live music
- any playing of recorded music
- a performance of dance
- entertainment of a similar description to that falling within a performance of live music, any playing of recorded music or a performance of dance
- entertainment facilities for making music
- entertainment facilities for dancing
- entertainment of a similar description to that falling within entertainment facilities for making music or dancing
- provision of late night refreshment
- the sale by retail of alcohol

THE TIMES THE LICENCE AUTHORISES THE CARRYING OUT OF LICENSABLE ACTIVITIES

Activity (and Area if applicable)	Description	Time From	Time To
A. Performance of a play (Indoors & Outdoors)	Monday to Sunday	7:00pm	Midnight
B. Exhibition of films (Indoors)	Monday to Sunday	7:00pm	Midnight
C. Indoor sporting event	Monday to Sunday	Noon	Midnight
E. Performance of live music (Indoors & Outdoors)	Monday to Sunday	7:00pm	1:00am
	Christmas Eve	7:00pm	2:00am



THE TIMES THE LICENCE AUTHORISES THE CARRYING OUT OF LICENSABLE ACTIVITIES continued ...

Activity (and Area if applicable)	Description	Time From	Time To
E. Performance of live music (Indoors & Outdoors) continued ...	New Years Eve	7:00pm	2:00am
F. Playing of recorded music (Indoors)	Monday to Sunday	7:00pm	1:00am
	Christmas Eve	7:00pm	2:00am
	New Years Eve	7:00pm	2:00am
G. Performance of dance (Indoors & Outdoors)	Monday to Sunday	7:00pm	1:00am
H. Entertainment of a similar description to that falling within E, F, or G (Indoors & Outdoors)	Monday to Sunday	7:00pm	1:00am
I. Provision of facilities for making music (Indoors)	Monday to Sunday	7:00pm	1:00am
J. Provision of facilities for dancing (Indoors & Outdoors)	Monday to Sunday	7:00pm	1:00am
	Christmas Eve	7:00pm	2:00am
	New Years Eve	7:00pm	2:00am
K. Provision of facilities for entertainment of a similar description to that falling within I or J (Indoors & Outdoors)	Monday to Sunday	7:00pm	1:00am
	Christmas Eve	7:00pm	2:00am
	New Years Eve	7:00pm	2:00am
L. Late night refreshment (Indoors)	Monday to Thursday	11:00pm	1:00am
	Friday to Saturday	11:00pm	2:00am
M. The sale by retail of alcohol for consumption ON the premises only	Monday to Wednesday	10:00am	11:00pm
	Thursday	10:00am	Midnight
	Friday to Saturday	10:00am	1:00am
	Sunday	Noon	10:30pm
	Christmas Eve	10:00am	2:00am
	New Years Eve	10:00am	2:00am

THE OPENING HOURS OF THE PREMISES

Description	Time From	Time To
Monday to Wednesday	8:00am	Midnight
Thursday	8:00am	1:00am
Friday to Saturday	8:00am	2:00am
Sunday	8:00am	11:00pm



Licensing Act 2003

Premises Licence

PL000579

WHERE THE LICENCE AUTHORISES SUPPLIES OF ALCOHOL WHETHER THESE ARE ON AND / OR OFF SUPPLIES

- M. The sale by retail of alcohol for consumption ON the premises only

Part 2

NAME, (REGISTERED) ADDRESS, TELEPHONE NUMBER AND EMAIL (WHERE RELEVANT) OF HOLDER OF PREMISES LICENCE

Davyhulme Park Golf Club

Gleneagles Road, Davyhulme, Manchester, M41 8SA.
Telephone 0161 748 2260

REGISTERED NUMBER OF HOLDER, FOR EXAMPLE COMPANY NUMBER, CHARITY NUMBER (WHERE APPLICABLE)

NAME, ADDRESS AND TELEPHONE NUMBER OF DESIGNATED PREMISES SUPERVISOR WHERE THE PREMISES LICENCE AUTHORISES THE SUPPLY OF ALCOHOL

Peter Thomas HASLAM

Davyhulme Park Golf Club, Gleneagles Road, Urmston, Manchester, M41 8SA.
Telephone 0161 748 2260

PERSONAL LICENCE NUMBER AND ISSUING AUTHORITY OF PERSONAL LICENCE HELD BY DESIGNATED PREMISES SUPERVISOR WHERE THE PREMISES LICENCE AUTHORISES FOR THE SUPPLY OF ALCOHOL

Licence No. PA1063

Issued by Trafford

ANNEXES

ANNEX 1 - MANDATORY CONDITIONS

1. No supply of alcohol may be made under the premises licence -

- (a) at a time when there is no designated premises supervisor in respect of the premises, or
- (b) at a time when the designated premises supervisor does not hold a personal licence or his personal licence is suspended.

2. Every supply of alcohol under the premises licence must be made or authorised by a person who holds a personal licence in accordance with Section 19 of the Licensing Act 2003.

3. The admission of children to the exhibition of any film shall be restricted in accordance with Section 20 of the Licensing Act 2003.

4. Where the premises licence includes a condition that at specified times one or more individuals must be at the premises to carry out a security activity, each such individual must be licensed by the Security Industry Authority in accordance with Section 21 of the Licensing Act 2003.

ANNEX 2 - CONDITIONS CONSISTENT WITH THE OPERATING SCHEDULE



Licensing Act 2003

Premises Licence

PL000579

ANNEXES continued ...

1. Entry to the club is by key only, and must be authorised by staff and members of the club,
2. Peninsula Business Services shall be employed to ensure that legal obligations are complied with.
3. The club has a 'Good Neighbour' policy which shall be maintained.
4. Children attending social functions will be accompanied by their parents, or other suitable supervising adults.

ANNEX 3 - CONDITIONS ATTACHED AFTER A HEARING BY THE LICENSING AUTHORITY

n/a



Signature of Authorised Officer



APPENDIX C

Representations from local residents

C1 – Nelson

C2 – Corrigan

C3 - Martin

C4 – Murphy

C5 – Seccombe

C1

Jan Taylor
Licensing Officer
Regulatory Services
Trafford Council
Licensing Section
Trafford Town Hall
Talbot Road
Stretford
Manchester
M32 0TH

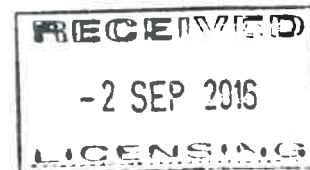

28th August, 2016

Dear Jan Taylor

We would like you to know that we strongly object.

Their public entertainment has increased substantially over the past few years and has become so loud that it is becoming unbearable. We currently have to now endure regular Friday and Saturday events with doors open wide and people screaming accompanied with excessive noise levels of music.

We would like to ask the question: - If this were a members event would they allow such behavior especially when it affects their local neighborhood and compromises the good name that they once held with all residents.

We do of course realise that in the modern world their golf club is required to look into alternative forms of income, and we feel that the residents have been very receptive to that, however the thought of our peaceful Sunday's being totally disrupted on top of enduring their regular weekend noise levels and disruption until the early hours of the evening is just totally unacceptable, and we therefore **object most strongly**

Yours sincerely

Linda and Andrew Nelson
29 Gleneagles Road

-----Original Message-----

From: Eric Corrigan

Sent: 19 August 2016 12:34

To: Licensing

Subject: Daveyhulme Park Golf Club (LA2003DOC25)

C2
Rep

I, and my neighbours, have received a note through the door from Daveyhulme Park Golf Club stating they have applied for an extension of their licence to sell alcohol on Sundays. I object to the later extension from 22:30 to 23:30 due to the noise cause by customers drinking outside the building and when leaving the premises after closing time.

From Eric Corrigan 35 Gleneagles road

Sent from my iPad

8/23/2016

Davyhulme Park Golf Club Variation to Premises Licence

C3

From: Graham Martin

To: licensing <licensing@trafford.gov.uk>

Subject: Davyhulme Park Golf Club Variation to Premises Licence

Date: Sun, 21 Aug 2016 13:26

Dear Sirs,

I wish to object to the above variation on the following grounds.

- 1 Increased noise later in the evening , especially from loud base music This already happens on a Saturday.
- 2 Increased parking on Gleneagles road , when Golf club park full.
- 3 Late night Sunday footfall on Gleneagles
- 4 Late night pedestrian noise , fueled by extended drinking hours on a Sunday evening.

Yours Faithfully



23/08/16

G Martin
23 Gleneagles Road
M41 8SA

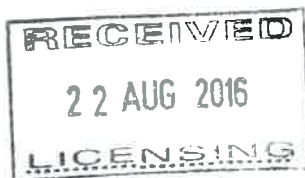

C4
J. L. Murphy
27 Gleneagles Road
Manchester M41 8SA

Joanne Boyle
Licensing Team Leader
Trafford Council
Trafford Town Hall
Talbot Road
Stretford
Manchester M32 0TH

REP

Dear Ms Boyle

Re Application for a variation to premises licence by Davyhulme Park Golf Club dated 28. 07. 2016.

I wish to make representation in relation to the above, briefly outlined below:-

The application states that the club would like to extend there licence to allow Regulated Entertainment including Singing, Dancing, Live Performers, Playing of Recorded Music etc. and serve alcohol generally throughout the day up 23:30hrs on a Sunday evening.

My concern is that this extends the existing license time in the evening on a Sunday from 22:30hrs. to 23:30hrs.

The majority of the local residents have to go to work or attend to family commitments on a Monday morning from around 07:00hrs. Given that most licensed premises can take up to an hour (or more) to be cleared of people which could bring the time to around 00:30hrs. effectively the next day. Giving rise to the noise of people and traffic leaving the premises when the majority of local residents, some with young children are trying to get to sleep.

The Golf Club already has the facility for late venues on Friday and Saturday nights please spare the local residents from typically the strains of an out of tune rendition of "New York, New York" on a Sunday evening/Monday morning as well as the already licensed Friday and Saturday evenings.

Whilst appreciating we are fortunate to live in a good location facing a very nice golf club, quite frankly 11:30hrs is just too late on a Sunday for these proposals in a quiet residential area.

Yours faithfully

Jack L. Murphy

-----Original Message-----

From: Elizabeth Seccombe

Sent: 26 August 2016 23:21

To: Licensing

Subject: Davyhulme park golf club Gleneagles Road. New Sunday License

C5

REP

Dear Sir,

I would like to object to the proposed extended licensing hours. We have a lot of traffic and parking problems on Sunday's from the football teams and this will now be extended to late into the night. Noise from the club , taxis and cars rushing away from the club etc.

Thank you

Mrs E Seccombe

53 Gleneagles Road

Flixton

Manchester.

M428SB

Sent from my iPad